

# SC15G

## Standard Compressor

### R134a

### 220-240V 60Hz

#### Data Sheet

#### General

Compressor	<b>SC15G</b>
Code number	104G8526

#### Application

Application		MBP
Evaporating temperature range	°C	-20 to 10
Voltage range	V/Hz	198 - 254 /60
Motor type		CSIR
Max. ambient temperature	°C	43
Comp. cooling at ambient temp.	32°C	F <sub>2</sub>
	38°C	F <sub>2</sub>
	43°C	F <sub>2</sub>

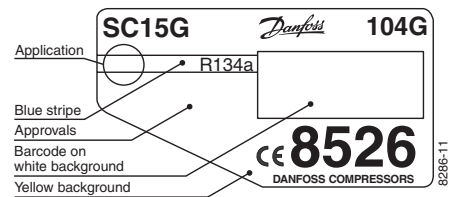

- S = Static cooling normally sufficient
- O = Oil cooling
- F<sub>1</sub> = Fan cooling 1.5 m/s  
(compressor compartment temperature equal to ambient temperature)
- F<sub>2</sub> = Fan cooling 3.0 m/s necessary

#### Design

Displacement	cm <sup>3</sup>	15.28
Oil quantity	cm <sup>3</sup>	550
Maximum refrigerant charge	g	1300
Free gas vol. in compressor	cm <sup>3</sup>	1410
Weight without electrical equipment	kg	13.1

#### Motor

Motor size	watt	470
LRA (rated after 4 sec. UL984) HST	A	19.7
Cut-in current HST	A	19.7
Resistance, main and start winding (25°C)	Ω	4.3/15.3
Approvals		-

#### Dimensions

Height	mm	A	219
		B	213
		B1	193
		B2	110
Suction connector	location/I.D. mm	C	10.2 ±0.09
Process connector	location/I.D. mm	D	6.5 ±0.09
Discharge connector	location/I.D. mm	E	6.5 ±0.09
Compressors on a pallet	pcs.		80

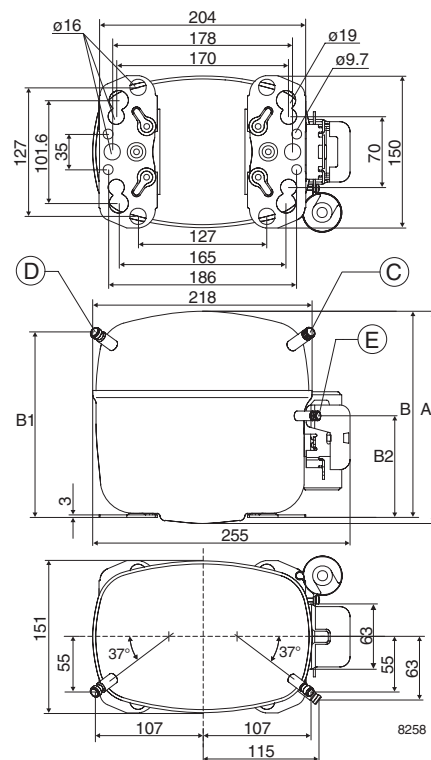

**Capacity (EN 12900/CECOMAF)**
**watt**

Comp.\°C	-20	-15	-10	-5	0	5	7.2	10
SC15G	374	510	672	855	1061	1291	1398	1543

**Capacity (ASHRAE)**
**watt**

Comp.\°C	-20	-15	-10	-5	0	5	7.2	10
SC15G	460	626	827	1053	1296	1596	1733	1912

**Power consumption**
**watt**

Comp.\°C	-20	-15	-10	-5	0	5	7.2	10
SC15G			496			690		

**Current consumption**
**A**

Comp.\°C	-20	-15	-10	-5	0	5	7.2	10
SC15G			3.05			3.70		

**COP (EN 12900/CECOMAF)**
**W/W**

Comp.\°C	-20	-15	-10	-5	0	5	7.2	10
SC15G			1.35			1.87		

**COP (ASHRAE)**
**W/W**

Comp.\°C	-20	-15	-10	-5	0	5	7.2	10
SC15G			1.67			2.31		

Test conditions	EN 12900/CECOMAF	ASHRAE
Condensing temperature	55°C	55°C
Ambient and suction gas temp.	32°C	32°C
Liquid temperature	55°C	32°C
Fan cooling F <sub>2</sub> , 220V 60Hz		
preliminary data		

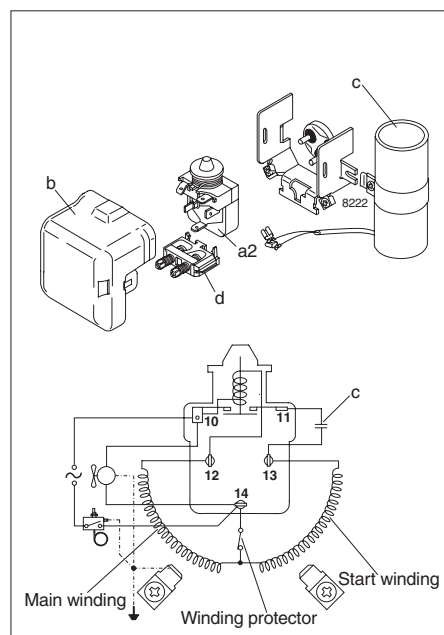
**Accessories**

Devices	Fig.	SC15G
Starting Relay	a2	117U6011
Cover	b	103N2009
Starting capacitor 80 µF	c	117U5017
Cord relief	d	103N1004
Mounting accessories		
Bolt joint for one compressor		118-1917
Bolt joint in quantities		118-1918
Snap-on in quantities		118-1919